

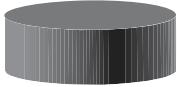

2010 ICE BREAKER VIP PACKAGES

October 8 - 10 - Scottrade Center



BUD LIGHT ZONE TABLE (For 4) **

\$1,550 TOTAL

Amenities Include:

- Four All-Session tickets in the first four rows on the glass.
- One reserved table (seats four) in the first row of the Bud Light Zone.
- Food and beverage in the Bud Light Zone each day.
- One sponsor gift.
- One parking pass or four Metro passes each day on October 8 and 10.
- Four tickets to the 2011 NCAA Men's Ice Hockey Regional at Scottrade Center (March 25 - 26).

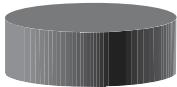

HOCKEY FANATIC PACKAGE (For 2) **

\$750 TOTAL

Amenities Include:

- Two All-Session tickets in the first four rows on the glass.
- Food and beverage in the Bud Light Zone each day.
- One parking pass per day or two Metro passes each day on October 8 and 10.
- Two tickets to the 2011 NCAA Men's Ice Hockey Regional at Scottrade Center (March 25 - 26).

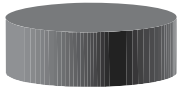

TRAVEL PACKAGE (For 2)

\$1,400 TOTAL

Amenities Include:

- Two All-Session tickets in the first four rows on the glass.
- Food and beverage in the Bud Light Zone each day.
- One hotel room (double occupancy) for Oct. 8, 9 and 10 at Hilton St. Louis at the Ballpark.
- Two four-day Metro passes.
- One sponsor gift.
- Two tickets to the 2011 NCAA Men's Ice Hockey Regional at Scottrade Center (March 25 - 26).

* Reserve your VIP Package now for the 2010 and 2011 Ice Breaker and receive 10% off the package price.

** VIP Package buyers have the opportunity to add hotel rooms to these packages for \$115 a night.

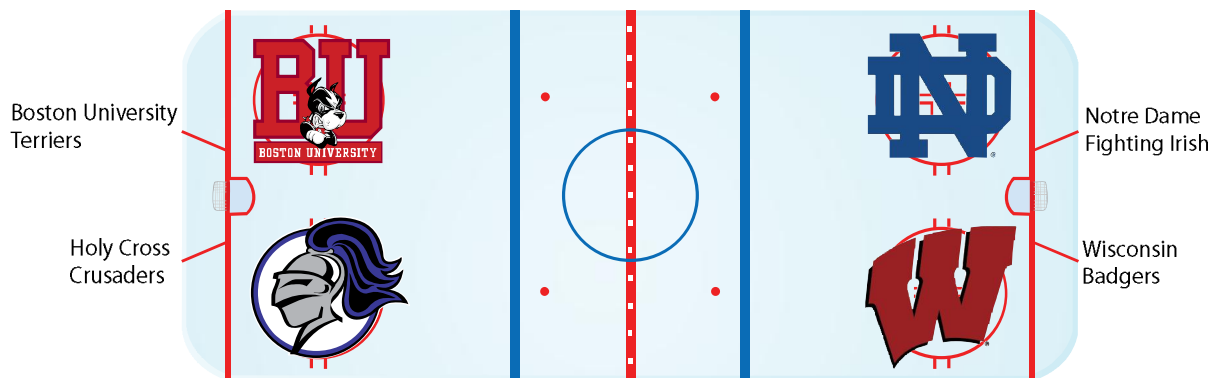

A limited number of VIP packages are available and will be sold on a first-come, first-served basis.

To reserve a Ice Breaker VIP package, please complete the attached order form or contact Karli Juenger at (314) 345-5111 or e-mail kjuenger@stlsports.org.

2010 ICE BREAKER VIP PACKAGES

October 8 - 10, 2010 - Scottrade Center

**RESERVATION
FORM**

Name: _____

Company: _____

Address: _____

City: _____ State: _____ Zip: _____

Phone: _____ E-mail: _____

Yes! I would like to purchase one or more of the following Bud Light Zone Packages.
_____ # of Bud Light Zone Packages at \$1,550 = \$ _____

Yes! I would like to purchase one or more of the following Hockey Fanatic Packages.
_____ # of Hockey Fanatic Packages at \$750 = \$ _____

Yes! I would like to purchase one or more of the following Travel Packages.
_____ # of Hockey Travel Packages at \$1,400 = \$ _____

Yes! I would like to add additional hotel room nights at \$115 a night. = \$ _____

Yes! I would like to reserve my package for 2011 (10% discount). = \$ _____

Transportation Options: Parking spot Metro passes TOTAL = \$ _____
(Please check one)

FORM OF PAYMENT

Check enclosed (Payable to St. Louis Sports Commission) MasterCard (Preferred card of the Sports Commission) Visa American Express

Name on Card: _____

Credit Card Billing Address: _____

Credit Card #: _____

Exp. Date: _____ **Card Security Code: _____ Signature: _____

**Last 3 digits on signature line on back of credit card. 4 digit code on front of card for American Express.

Please return by fax (314) 621-1391 or mail to:

St. Louis Sports Commission | Attn: Karli Juenger | 308 N. 21st Street - Suite 500 | St. Louis, MO 63103

For questions, please call (314) 345-5111.

